

TUCSON UNIFIED

SCHOOL DISTRICT

eXtended
day education



Extended Day Credit Recovery Sites

❖ Currently implemented at 5 High School Sites

- 1) Catalina
- 2) Pueblo
- 3) Sabino
- 4) Sahuaro
- 5) Santa Rita

❖ The following sites will be implementing Extended Day Credit Recovery

- 1) Cholla
- 2) Palo Verde
- 3) Rincon
- 4) Tucson

TUCSON UNIFIED SCHOOL DISTRICT



*All students are invited to
participate in these
opportunities.*

*Transportation & Supper
available.*

CATALINA

Culinary Arts

M, T, Th 3:45 p.m. – 5:30 p.m.

Credit Recovery

M, T, Th 3:45 p.m. – 5:30 p.m.

PUEBLO

Healthcare Foundations

M, T, Th 3:20 p.m. – 5:25 p.m.

Credit Recovery

M, T, Th 7:05 a.m. – 7:55 a.m.

M, T, Th 3:20 p.m. – 4:20 p.m.

SABINO

Credit Recovery

M, T, Th 3:20 p.m. – 4:35 p.m.

SAHUARO

Credit Recovery

M, T, Th 3:20 p.m. – 4:30 p.m.

SANTA RITA

Credit Recovery

M, T, Th 3:30 p.m. – 6:00 p.m.

**For More Information, Contact
Tamara Hille or Charles McCollum**

Extended Day Credit Recovery Overview

- ❖ Provides an opportunity for Tucson Unified high school students to earn credit for a course(s) previously failed
- ❖ Students are able to enroll in the credit recovery course for 1 or 2 periods after the regular school day ends
- ❖ Credit recovery implementation in the classroom after school matches what is being implemented during the regular school day

Extended Day Credit Recovery Process

- ❖ Counselors look at list of students who are credit deficient
 - ❖ Seniors have top priority due to graduation
- ❖ Counselors communicate with student and parent/guardian regarding Extended Day Learning Credit Recovery option
- ❖ If parent/guardian gives permission for this option, student is then placed in the Extended Day course(s)
- ❖ If parent/guardian does not provide permission, site has them fill out an Opt Out form stating he/she does not want student to participate

Extended Day Credit Recovery Transportation

- ❖ Transportation is currently being provided from Rincon to Catalina.
- ❖ Numbers became too large for sites to accommodate, thus the implementation of programs at Cholla, Palo Verde, Rincon and Tucson High.

Current Enrollment at Extended Day Learning Sites

	Santa Rita	Pueblo	Catalina	Sabino	Sahuaro
Total Enrollment	21	75	43	36	71

Average Number of Credit Deficiencies for Extended Day Learning Students

Cohort Year	Avg Credits Earned	Avg Credits Needed
2017	21.50	1.50
2018	15.68	7.32
2019	13.40	9.60
2020	9.09	13.91

Supper Program at Extended Day Learning Sites

- ❖ Sabino and Sahuaro are new to the Supper Meal Program this year due to Extended Day Learning

	Santa Rita	Pueblo	Catalina	Sabino	Sahuaro
8/20	98	125	87	11	11
8/21	98	51	80	13	10
8/22	60	75	69	N/A	N/A
8/23	50	78	93	14	13
8/24	26	75	86	22	4
8/27	99	95	100	30	12
8/28	92	90	85	30	9
8/29	48	100	80	N/A	N/A
8/30	55	90	100	30	20
8/31	30	100	96	26	27

Extended Day Credit Recovery for Late Enrolling Students

- ❖ For students enrolling late into a semester, extended day credit recovery should be utilized, if possible.
- ❖ Goal is to support the student in an online learning environment in order to earn credit
- ❖ For the next semester, student would then have a more traditional schedule

CTE

CAREER and TECHNICAL EDUCATION



TUCSON UNIFIED
SCHOOL DISTRICT

Catalina High School

- ▶ Culinary Arts: 21 Students
 - ▶ Rincon
 - ▶ Catalina
 - ▶ Project More
 - ▶ Pueblo

Pueblo High School

- ▶ Health Care Foundations : 15 Students
 - ▶ Pueblo
 - ▶ Cholla
 - ▶ Project More

CTE

CAREER and TECHNICAL EDUCATION



TUCSON UNIFIED
SCHOOL DISTRICT

Current CTE/JTED Enrollment: 434

CTE Programs at Santa Rita

1. Agribusiness Systems	40
2. Bioscience	49
3. Business Management Systems	140
4. Construction Technologies	41
5. Software & App Development	50

Pima JTED Land Leased Programs at Santa Rita

1. 3D Animation	19
2. Culinary Arts	95

CTE

CAREER and TECHNICAL EDUCATION



TUCSON UNIFIED
SCHOOL DISTRICT

Proposed Future Expansion at Santa Rita

DENTAL ASSISTING

DIESEL ENGINE REPAIR

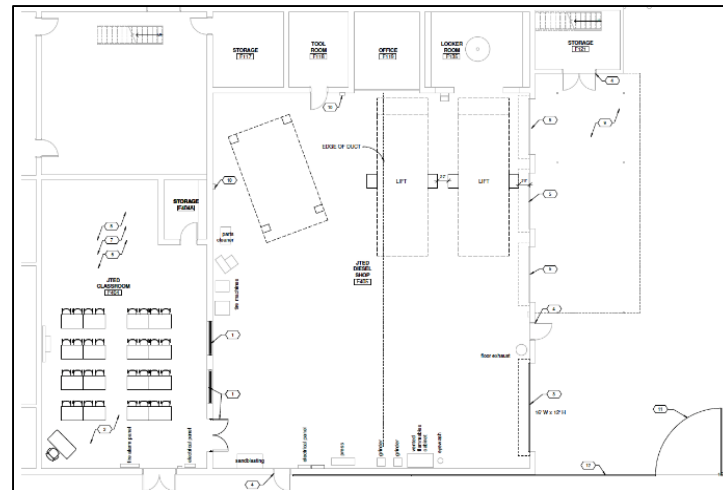
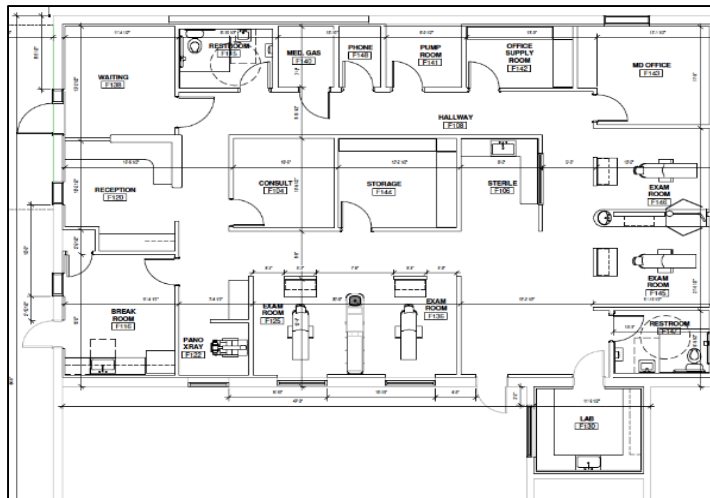

Phase 1 (completed) Architectural Plans, Supplies & Equipment cost estimates

Phase 2 Pending Governing Board Approval Secure Vendors/Contractors

Phase 3 Pending Governing Board Approval Construction Begins
Completion Goals for both projects SY 19-20